

# Intelligent Dynamic WDS

---



It Is A Manufacture Intergrating R&D, Production Processing, Distribution And After-Sales

**AGV RGV Intelligent Dynamic Gear**

**WDS**

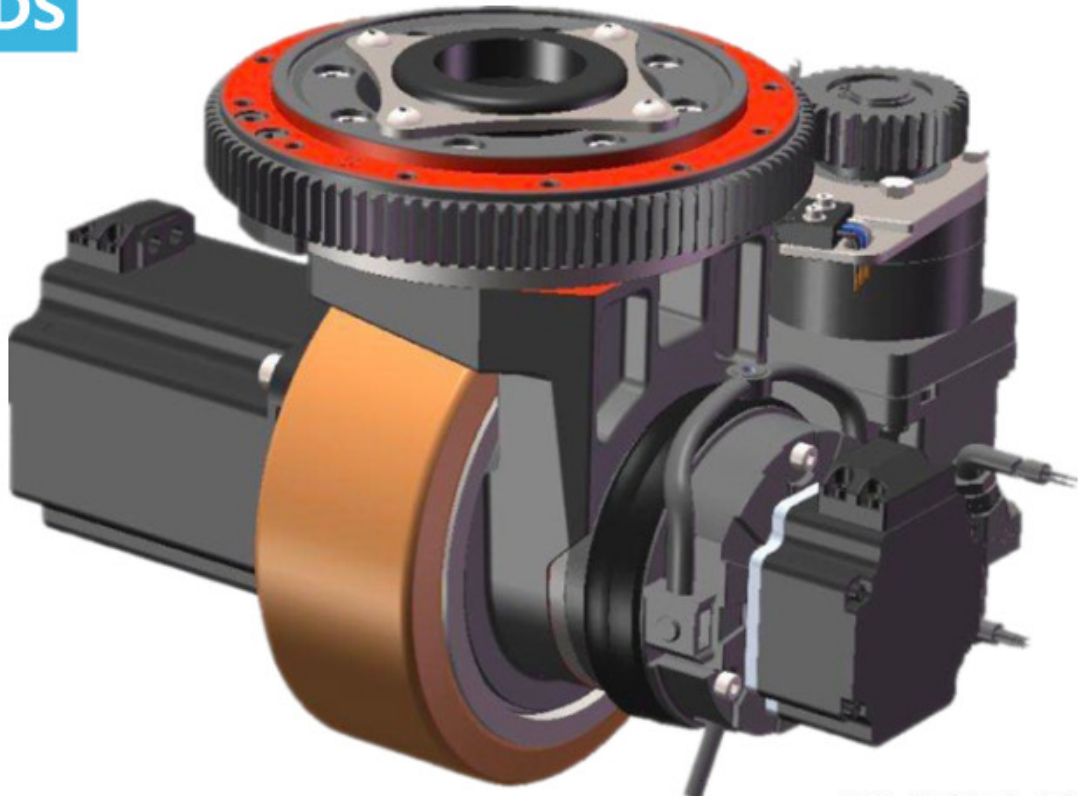

**WIDE RANGE**

of Products

**STRONG**

Economic Foundation

**COMPLETE**

Technology & Staffing

## WDS Series Reducer characteristics:

- 1, Helical gear transmission, carburizing and quenching treatment, tooth profile modification treatment, to ensure low noise and smooth operation. The bearing capacity is 20% higher than that of straight teeth.
- 2, Integral output shaft and bearing support at both ends of planetary wheel to achieve high precision and strength.
- 3, The backlash clearance is small, and the precision single stage can achieve less than 3 arc min.

# Intelligent Dynamic WDS

---

## Product features

Precision planetary gear reducer is a new generation of practical products independently developed by our company, which has the following main characteristics.

### 1,Low noise

below 65db

### 2,High input speed

Up to 5000RPM

### 3,Low Backlash

One stage within 3 arc minutes, two stage with 5 arc/min

### 4,High torque

Higher than conventional planetary gearbox

### 5,High efficiency

One Stage is exceed97%,Two stage is exceed 95%

### 6,High stability

Using high-strength steel alloy material .Not just hardening on gear surface, but hardening entire gear to insure the gear life time and maintain high accuracy.

## Product Application

**Precision planetary gear reducer is widely used in the following fields**

01 , Aerospace ,military industries

02, Medical health care, electronic information technology industry.

03,Industrial robot, production automation ,CNC machine tool manufacturing industry

04, Motor, textile, printing, food, metallurgical, environmental protection engineering, warehouse and logistics industry.

# Intelligent Dynamic WDS

## Description Reducer:

ZL	WDS	150	200	200	48	70		
↑	↑	↑	↑	↑	↑	↑		
								Ratio (Refer to the inside page for details)
								Volatage
								Steering motor Power
								Driving Motor Power
								Wheel diameter
								Horizontal steering wheel(S on behalf of the one-wheel)

Company name

## WDS150 Series

ZL-WDS-150-400-200-48-70(20)

ZL-WDS-150-200-200-48-70  
ZL-WDS-150-200-200-48-20

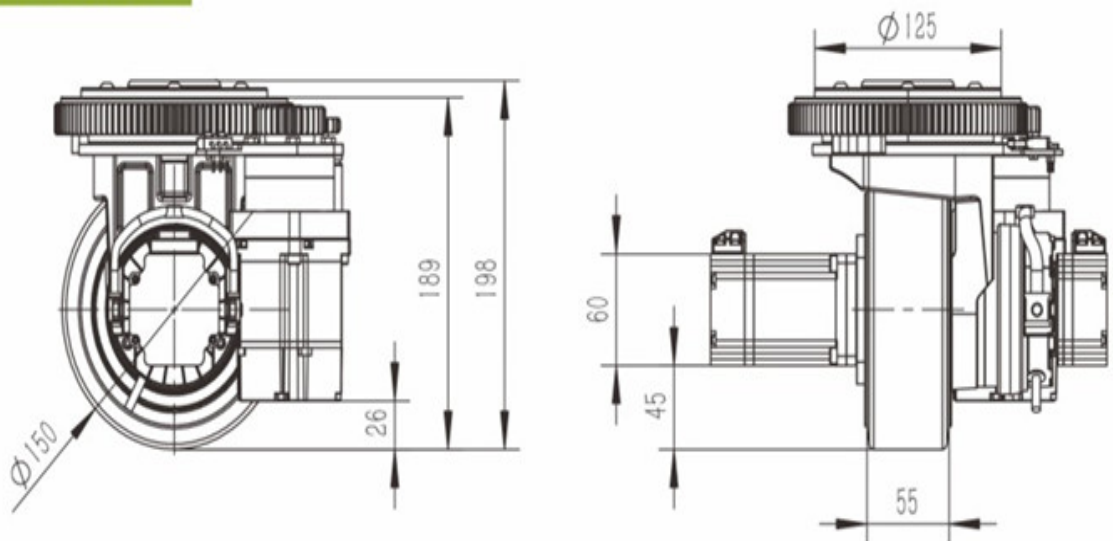

# Intelligent Dynamic WDS

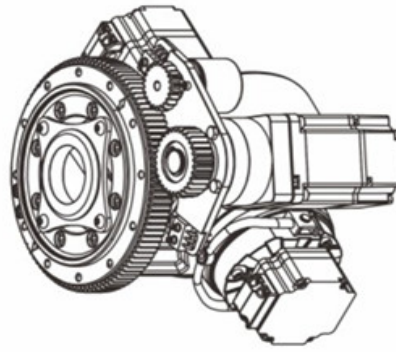
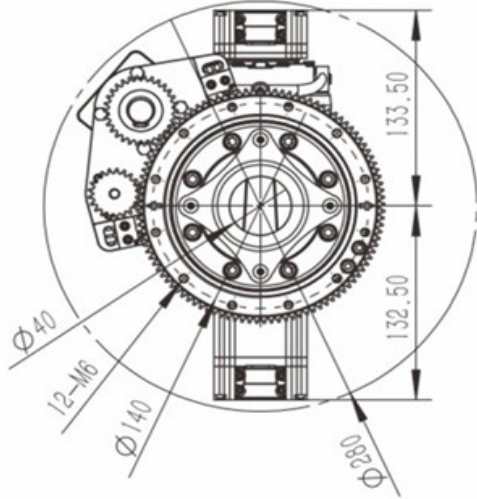

Traction motor parameters		Motor Power	Motor Voltage	Motor speed	Motor current	Rated torque	IP Grade	Encoder	
Type	DC	W	V	RPM	A	Nm	IP	Magnetic braiding	Resolution ratio
	Servo Motor	200	48	3000	5.1	0.64	65	Increment	1024

Traction reducer parameters	Type	X	Planetary reducer	
	Reducer speed ratio	i	20	68
	Reducer torque	Nm	100	120
	Polyurethane Loaded	Kg	1000	
	Rubber Loaded	Kg	900	
	Braking torque	Nm	76	258.4
	Actuators torque	Nm	4	4
	Actuators Voltage	V	DC24	DC24
	Maximum speed	M/min	70.7	20.8
	Traction	N	162	522.24
	Traction weight	reference	292	835.584

Steering motor parameters	Type	DC	Servo Motor
	Motor Power	W	200
	Motor Voltage	V	48
	Motor speed	RPM	3000
	Motor current	A	5.1
	Reducer speed ratio	i	35+ (105:30)
	Reducer torque	Nm	35
	IP Grade	IP	65
	Encoder	Magnetic braiding	Increment
		Resolution ratio	1024
	Left and right limit	IO	Always on, always off

# Intelligent Dynamic WDS

				Max steering Angle	±	140°
Another	Reducer lubrication	lubricant	(-20°~200°)			
	Dead-weight	Kg	About16			

ZL-WDS-150-400-200-48-70(20)

ZL-WDS-150-400-200-48-70  
ZL-WDS-150-400-200-48-20

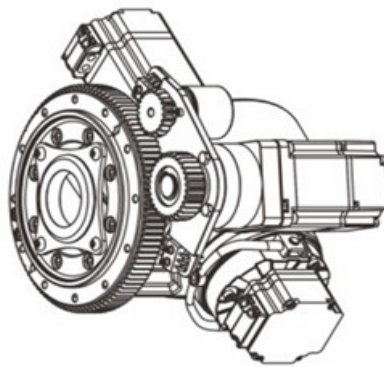
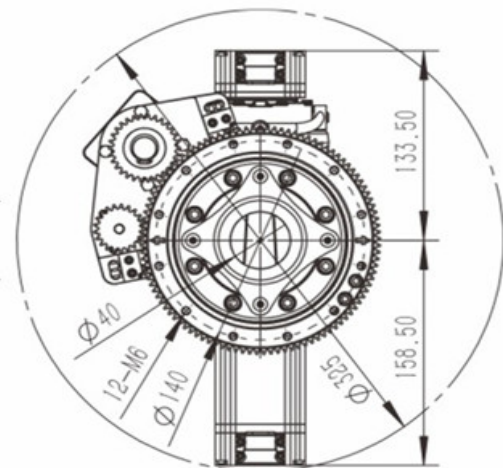
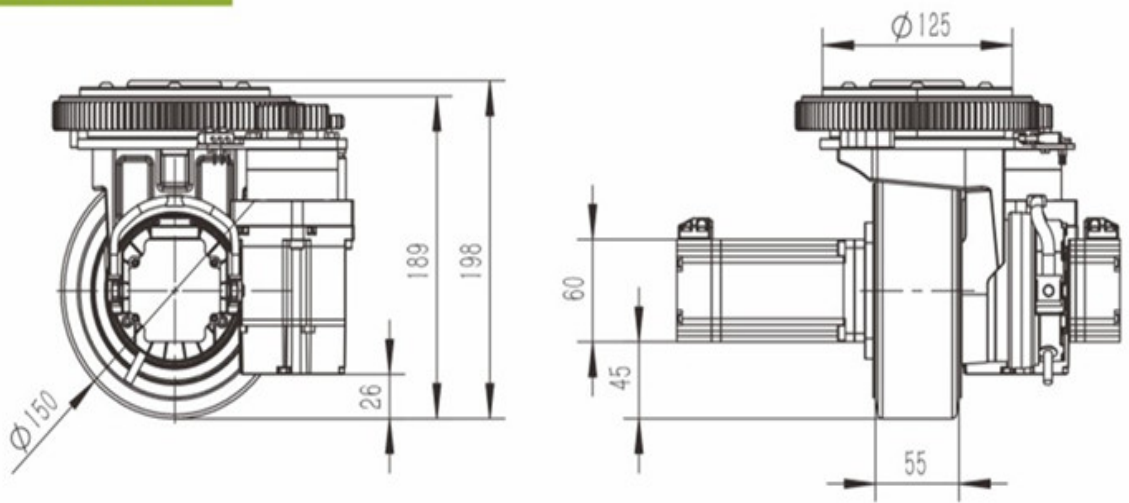

# Intelligent Dynamic WDS

Traction motor parameters		Motor Power	Motor Voltage	Motor speed	Motor current	Rated torque	IP Grade	Encoder	
Type	DC	W	V	RPM	A	Nm	IP	Magnetic braiding	Resolution ratio
	Servo Motor	400	48	3000	10.1	1.27	65	Increment	1024

Traction reducer parameters	Type	X	Planetary reducer	
	Reducer speed ratio	i	20	68
	Reducer torque	Nm	100	120
	Polyurethane Loaded	Kg	1000	
	Rubber Loaded	Kg	900	
	Braking torque	Nm	76	258.4
	Actuators torque	Nm	4	4
	Actuators Voltage	V	DC24	DC24
	Maximum speed	M/min	70.7	20.8
	Traction	N	322	1036.3
	Traction weight	reference	547	1658

Steering motor parameters	Type	DC	Servo Motor
	Motor Power	W	200
	Motor Voltage	V	48
	Motor speed	RPM	3000
	Motor current	A	5.1
	Reducer speed ratio	i	35+ (105:30)
	Reducer torque	Nm	35
	IP Grade	IP	65
	Encoder	Magnetic braiding	Increment
		Resolution ratio	1024
	Left and right limit	IO	Always on, always off
	Max steering Angle	±	140°

Another	Reducer lubrication	lubricant	(-20°~200°)
	Dead-weight	Kg	About16

# Intelligent Dynamic WDS

ZL-WDS-150-750-200-48-70(20)

ZL-WDS-150-750-200-48-70  
ZL-WDS-150-750-200-48-20

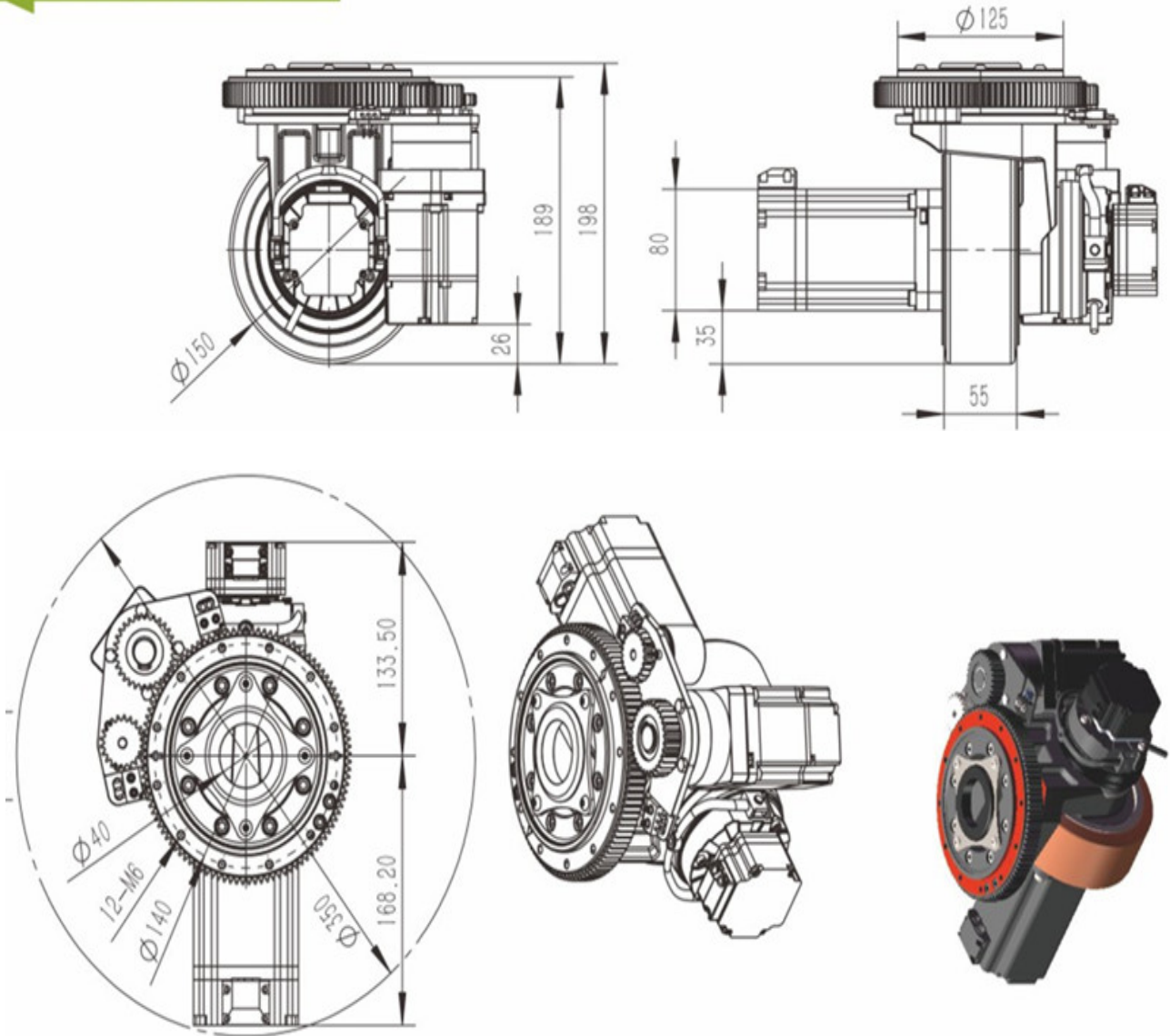

Traction motor parameters		Motor Power	Motor Voltage	Motor speed	Motor current	Rated torque	IP Grade	Encoder	
Type	DC	W	V	RPM	A	Nm	IP	Magnetic braiding	Resolution ratio
	Servo Motor	750	48	3000	19	2.39	65	Increment	1024

# Intelligent Dynamic WDS

Traction reducer parameter s	Type	X	Planetary reducer		Steering motor parameter s	Type	DC	Servo Motor
	Reducer speed ratio	i	20	68		Motor Power	W	200
	Reducer torque	Nm	100	120		Motor Voltage	V	48
	Polyurethane Loaded	Kg	1000			Motor speed	RPM	3000
	Rubber Loaded	Kg	900			Motor current	A	5.1
	Braking torque	Nm	76	258.4		Reducer speed ratio	i	35+ (105:30)
	Actuators torque	Nm	4	4		Reducer torque	Nm	35
	Actuators Voltage	V	DC24	DC24		IP Grade	IP	65
	Maximum speed	M/min	70.7	20.8		Encoder	Magnetic braiding	Increment
	Traction	N	605	1733.55			Resolution ratio	1024
	Traction weight	reference	1029	2600.32		Left and right limit	IO	Always on, always off
						Max steering Angle	±	140°
Another	Reducer lubrication	lubricant		(-20°~200°)				
	Dead-weight	Kg		About17				

# Intelligent Dynamic WDS

## WDS200 Series

ZL-WDS-200-750-200-48-75(20)

ZL-WDS-200-750-200-48-75  
ZL-WDS-200-750-200-48-20

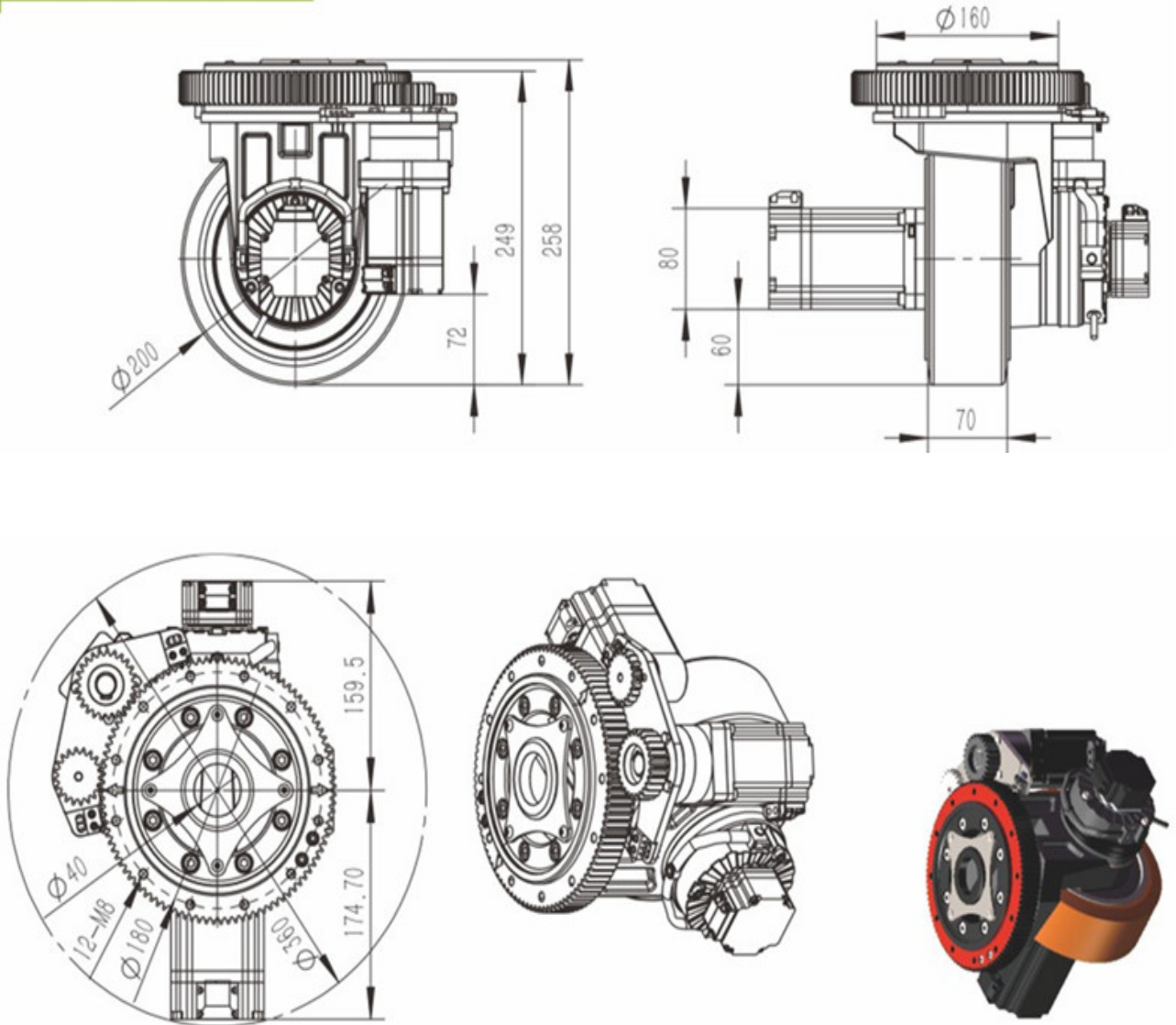

Traction motor parameters		Motor Power	Motor Voltage	Motor speed	Motor current	Rated torque	IP Grade	Encoder	
Type	DC	W	V	RPM	A	Nm	IP	Magnetic braiding	Resolution ratio
	Servo Motor	750	48	3000	19	2.39	65	Increment	1024

# Intelligent Dynamic WDS

Traction reducer parameter s	Type	X	Planetary reducer		Steering motor parameter s	Type	DC	Servo Motor
	Reducer speed ratio	i	25	85		Motor Power	W	200
	Reducer torque	Nm	250	310		Motor Voltage	V	48
	Polyurethane Loaded	Kg	1500			Motor speed	RPM	3000
	Rubber Loaded	Kg	1380			Motor current	A	5.1
	Braking torque	Nm	190	646		Reducer speed ratio	i	35+ (100:25)
	Actuators torque	Nm	8	8		Reducer torque	Nm	35
	Actuators Voltage	V	DC24	DC24		IP Grade	IP	65
	Maximum speed	M/min	75.4	22.2		Encoder	Magnetic braiding	Increment
	Traction	N	568	1218.9			Resolution ratio	1024
	Traction weight	reference	851	1828.35		Left and right limit	IO	Always on, always off
					Max steering Angle	±	140°	
Another	Reducer lubrication		lubricant		(-20°~200°)			
	Dead-weight		Kg		About24			

# Intelligent Dynamic WDS

ZL-WDS-200-1200-400-48-75(20)

ZL-WDS-200-1200-400-48-75  
ZL-WDS-200-1200-400-48-20

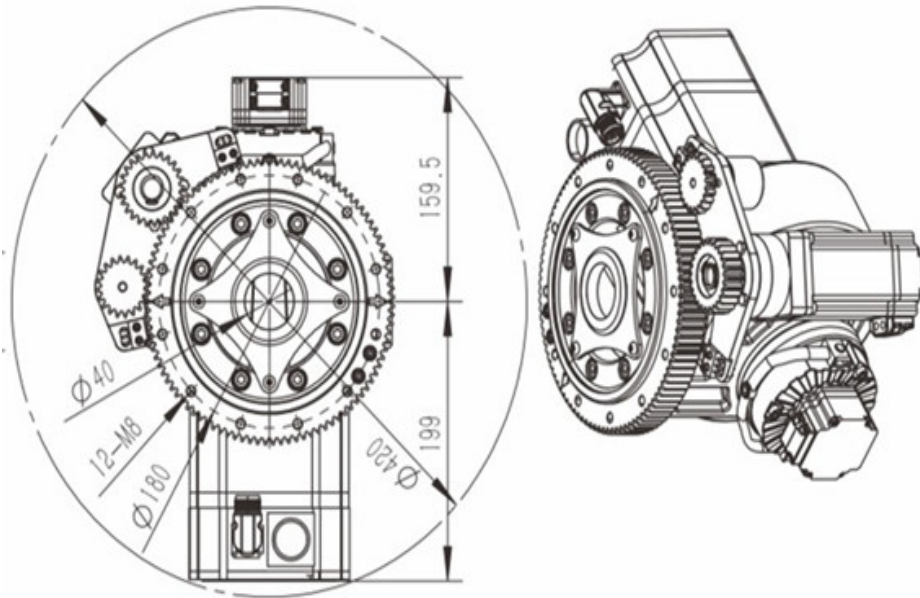
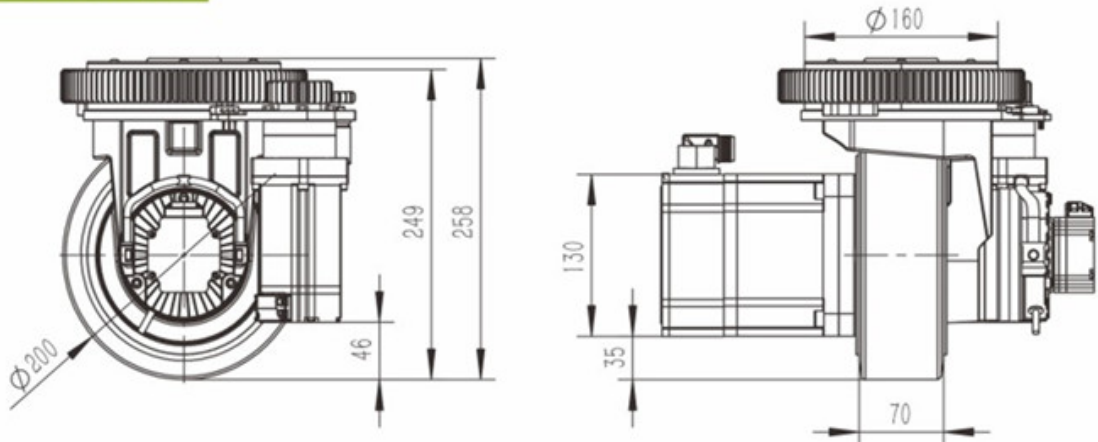

Traction motor parameters		Motor Power	Motor Voltage	Motor speed	Motor current	Rated torque	IP Grade	Encoder	
Type	DC	W	V	RPM	A	Nm	IP	Magnetic braiding	Resolution ratio
	Servo Motor	1200	48	3000	31.6	3.8	65	Increment	1024

# Intelligent Dynamic WDS

Traction reducer parameter s	Type	X	Planetary reducer		Steering motor parameter s	Type	DC	Servo Motor
	Reducer speed ratio	i	25	85		Motor Power	W	400
	Reducer torque	Nm	250	310		Motor Voltage	V	48
	Polyurethane Loaded	Kg	1500			Motor speed	RPM	3000
	Rubber Loaded	Kg	1380			Motor current	A	10.1
	Braking torque	Nm	190	646		Reducer speed ratio	i	35+ (100:25)
	Actuators torque	Nm	8	8		Reducer torque	Nm	35
	Actuators Voltage	V	DC24	DC24		IP Grade	IP	65
	Maximum speed	M/min	75.4	22.2		Encoder	Magnetic braiding	Increment
	Traction	N	903	1615			Resolution ratio	1024
	Traction weight	reference	1354	2422.5		Left and right limit	IO	Always on, always off
						Max steering Angle	±	140°
Another	Reducer lubrication	lubricant		(-20°~200°)				
	Dead-weight	Kg		About25				

# Intelligent Dynamic WDS

ZL-WDS-200-1500-400-48-75(20)

ZL-WDS-200-1500-400-48-75  
ZL-WDS-200-1500-400-48-20

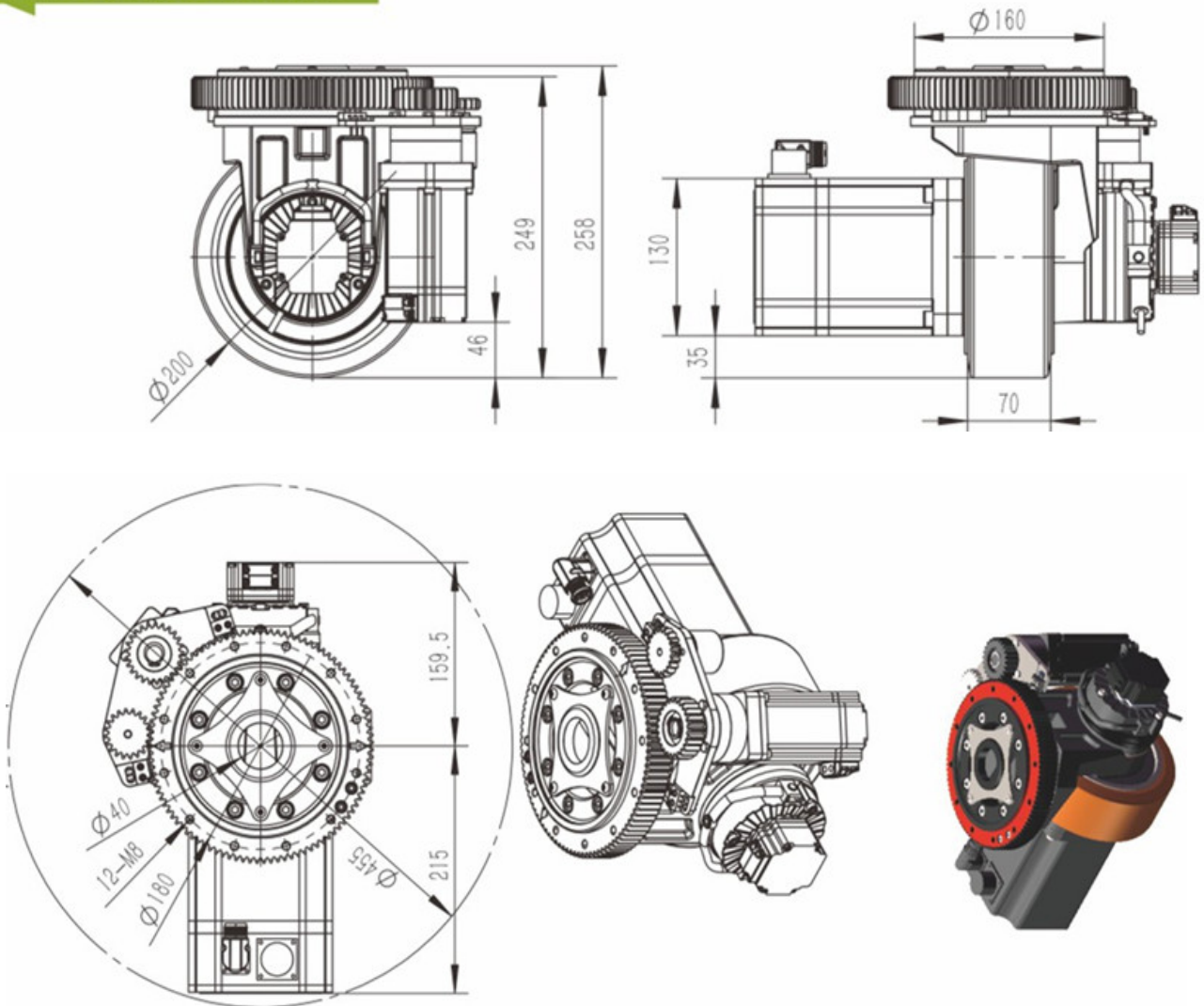

Traction motor parameters		Motor Power	Motor Voltage	Motor speed	Motor current	Rated torque	IP Grade	Encoder	
Type	DC	W	V	RPM	A	Nm	IP	Magnetic braiding	Resolution ratio
	Servo Motor	1500	48	3000	37.4	5	65	Increment	1024

# Intelligent Dynamic WDS

Traction reducer parameter s	Type	X	Planetary reducer		Steering motor parameter s	Type	DC	Servo Motor
	Reducer speed ratio	i	25	85		Motor Power	W	400
	Reducer torque	Nm	250	310		Motor Voltage	V	48
	Polyurethane Loaded	Kg	1500			Motor speed	RPM	3000
	Rubber Loaded	Kg	1380			Motor current	A	10.1
	Braking torque	Nm	190	646		Reducer speed ratio	i	35+ (100:25)
	Actuators torque	Nm	8	8		Reducer torque	Nm	35
	Actuators Voltage	V	DC24	DC24		IP Grade	IP	65
	Maximum speed	M/min	75.4	22.2		Encoder	Magnetic braiding	Increment
	Traction	N	1188	2125			Resolution ratio	1024
	Traction weight	reference	1781	3187.5		Left and right limit	IO	Always on, always off
				Max steering Angle	±	140°		

Another	Reducer lubrication	lubricant	(-20°~200°)
	Dead-weight	Kg	About26

# Intelligent Dynamic WDS

## WDS250 Series

ZL-WDS-250-1500-750-48-90(25)

ZL-WDS-250-1500-750-48-90  
ZL-WDS-250-1500-750-48-25

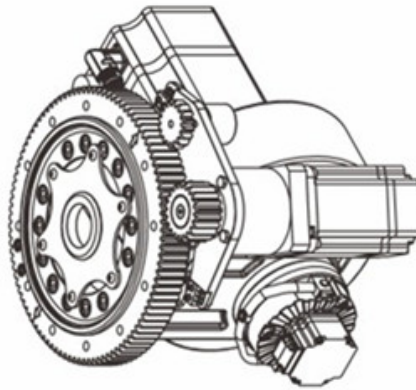
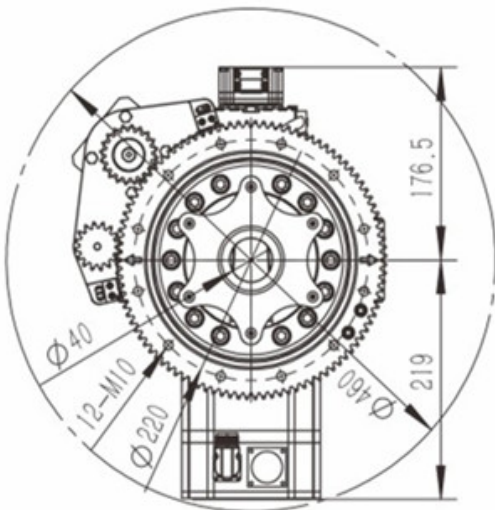
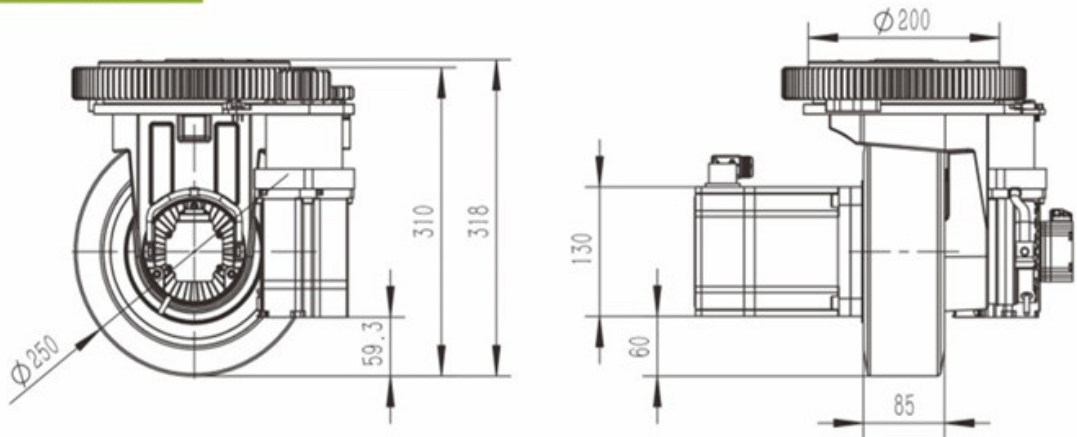

Traction motor parameters		Motor Power	Motor Voltage	Motor speed	Motor current	Rated torque	IP Grade	Encoder	
Type	DC	W	V	RPM	A	Nm	IP	Magnetic braiding	Resolution ratio
	Servo Motor	1500	48	3000	37.4	5	65	Increment	1024

# Intelligent Dynamic WDS

Traction reducer parameter s	Type	X	Planetary reducer		Steering motor parameter s	Type	DC	Servo Motor
	Reducer speed ratio	i	25	85		Motor Power	W	750
	Reducer torque	Nm	250	310		Motor Voltage	V	48
	Polyurethane Loaded	Kg	2000			Motor speed	RPM	3000
	Rubber Loaded	Kg	1800			Motor current	A	19
	Braking torque	Nm	190	646		Reducer speed ratio	i	35+ (100:20)
	Actuators torque	Nm	8	8		Reducer torque	Nm	105
	Actuators Voltage	V	DC24	DC24		IP Grade	IP	65
	Maximum speed	M/min	94.2	27.7		Encoder	Magnetic braiding	Increment
	Traction	N	950	1700			Resolutio n ratio	1024
	Traction weight	reference	1425	2550		Left and right limit	IO	Always on, always off
				Max steering Angle	±	140°		

Another	Reducer lubrication	lubricant	(-20°~200°)
	Dead-weight	Kg	About30

# Intelligent Dynamic WDS

ZL-WDS-250-2000-750-48-90(25)

ZL-WDS-250-2000-750-48-90  
ZL-WDS-250-2000-750-48-25

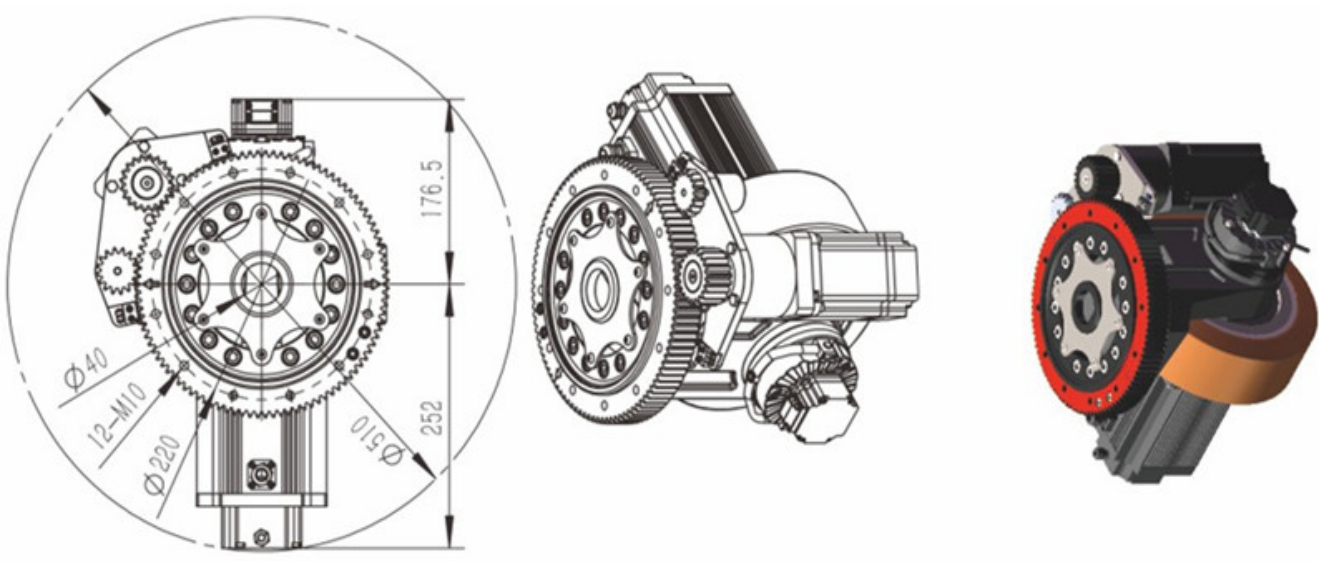
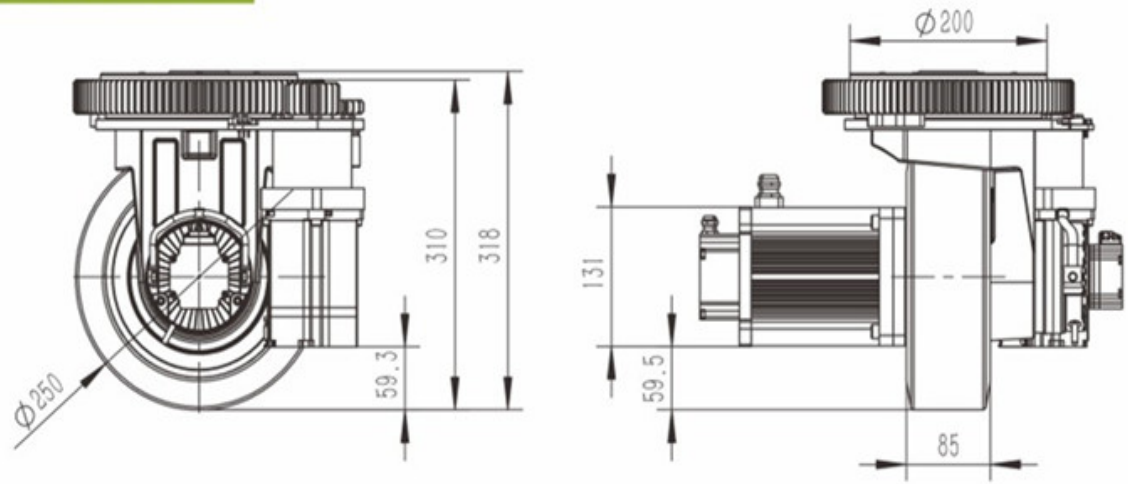

Traction motor parameters		Motor Power	Motor Voltage	Motor speed	Motor current	Rated torque	IP Grade	Encoder	
Type	DC	W	V	RPM	A	Nm	IP	Magnetic braiding	Resolution ratio
	Servo Motor	2000	48	3000	73.5	7.3	65	Increment	1024

# Intelligent Dynamic WDS

Traction reducer parameter s	Type	X	Planetary reducer		Steering motor paramet ers	Type	DC	Servo Motor
	Reducer speed ratio	i	25	85		Motor Power	W	750
	Reducer torque	Nm	250	310		Motor Voltage	V	48
	Polyurethane Loaded	Kg	2000			Motor speed	RPM	3000
	Rubber Loaded	Kg	1800			Motor current	A	19
	Braking torque	Nm	190	646		Reducer speed ratio	i	35+ (100:20)
	Actuators torque	Nm	8	8		Reducer torque	Nm	105
	Actuators Voltage	V	DC24	DC24		IP Grade	IP	65
	Maximum speed	M/min	94.2	27.7		Encoder	Magnetic braiding	Increment
	Traction	N	1387	2482			Resolution ratio	1024
	Traction weight	reference	2081	3723		Left and right limit	IO	Always on, always off
				Max steering Angle	±	140°		

Another	Reducer lubrication	lubricant	(-20°~200°)
	Dead-weight	Kg	About32

# Intelligent Dynamic WDS

ZL-WDS-250-3000-750-48-90(25)

ZL-WDS-250-3000-750-48-45  
ZL-WDS-250-3000-750-48-20

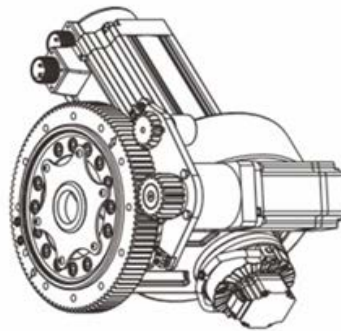
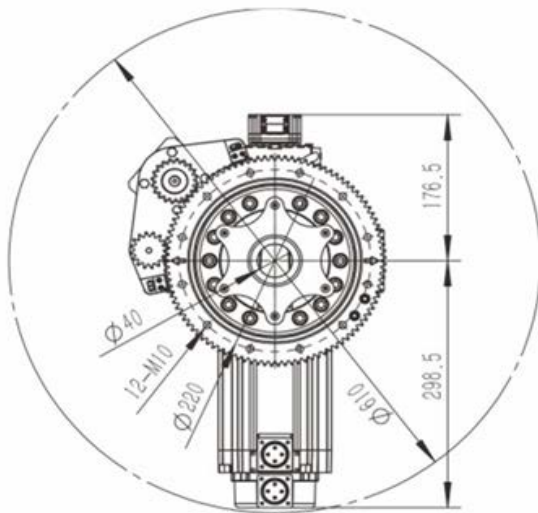
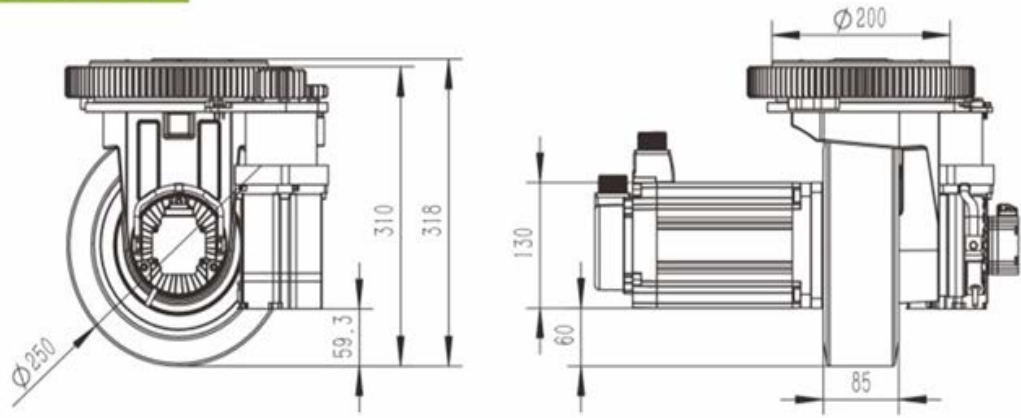

Traction motor parameters		Motor Power	Motor Voltage	Motor speed	Motor current	Rated torque	IP Grade	Encoder	
Type	DC	W	V	RPM	A	Nm	IP	Magnetic braiding	Resolution ratio
	Servo Motor	3000	48	1500	80	19.1	65	Increment	1024

# Intelligent Dynamic WDS

Traction reducer parameter s	Type	X	Planetary reducer		Steering motor paramet ers	Type	DC	Servo Motor
	Reducer speed ratio	i	25	56		Motor Power	W	750
	Reducer torque	Nm	250	310		Motor Voltage	V	48
	Polyuretha ne Loaded	Kg	2000			Motor speed	RPM	3000
	Rubber Loaded	Kg	1800			Motor current	A	19
	Braking torque	Nm	190	425.6		Reducer speed ratio	i	35+ (100:20)
	Actuators torque	Nm	8	8		Reducer torque	Nm	105
	Actuators Voltage	V	DC24	DC24		IP Grade	IP	65
	Maximum speed	M/min	47.1	21		Encoder	Magnetic braiding	Increment
	Traction	N	3056	4278.4			Resolution ratio	1024
	Traction weight	reference	4584	6417.6		Left and right limit	IO	Always on, always off
					Max steering Angle	±	140°	
Another	Reducer lubrication		lubricant		(-20°~200°)			
	Dead-weight		Kg		About35			

# Intelligent Dynamic WDS

---

## Delivery time :

Quantity(Pieces)	1 - 50	>50
Est. Time(days)	45	To be negotiated

## FAQ

### Q:Are you factory?

A:Yes, we are facotry, and we produce stepper motor and gearbox reducer and AGV RGV for more than 15 years in China.

### Q: What should I do, if I have no idea about parameter of motor and driver?

A:Please don't worry, send the picture and application to our professional sale, and we will give you the best suggestion.

### Q: How long is your products quality warranty?

A: We provide one year factory quality warranty.

### Q: How long is your delivery time?

A: When the order is confirmed, 7 working days for the small order,15~20 days for the bulk.

### Q:Can you offer me OEM service?

A:Yes,However,you should give me more request as you can.

### Q:How to choose suitable model?

A:Please provide a photo of the product you used before or advise us your needs, we will give suggestion .

### Q:What's your MOQ?

A:Normally one piece. If more, we can talk about discount. You can mix it with other Shenli machine parts shipping together .

### Q: What is your terms of payment ?

A: 100% in advance. Payment $\geq$ 50000USD, 50% T/T in advance, balance before shipment .

### Q: How does your QC work?

A: We have performance test ,Sampling test ,routing test and acceptance test.

### Q:Why choose your company?

A:We are a professional Industrial Solutions company in China. we're passed IS9001 international quality system certification; the products have respectively passed quality certification of CE, ROHS, FCC etc. Our brand quality can be supply high cost performance transmission control products for the world industrial control.